



High Road, Harrow Weald

£525,000 Freehold

This extended mid-terrace family home is perfectly located within one mile of Harrow & Wealdstone train station, Whitefriars Primary, Middle and High Schools, Salvatorian College and The Sacred Heart Language College. The accommodation comprises an entrance hall, through lounge, kitchen and dining area on the ground floor, whilst to the first floor there is a landing, three generously sized bedrooms and a family bathroom. To the front there is a cemented garden, whilst to the rear there is a garden which is mainly laid-to-lawn.

**EPC Rating: D
Council Tax Band: D**

• No Upper Chain • Extended Mid-Terrace Family Home • Three Generously Sized Bedrooms • Through Lounge • Kitchen • Dining Area • Bathroom • Rear Garden • Double-Glazed Windows • Gas Central Heating System



High Road, Harrow Weald

£525,000 Freehold

FURTHER DETAILS

The accommodation comprises an entrance hall, through lounge, kitchen and dining area on the ground floor, whilst to the first floor there is a landing, three generously sized bedrooms and a family bathroom. To the front there is a cemented garden, whilst to the rear there is a garden which mainly-laid-to-lawn.

LOCATION

The property is located within a short walk of the comprehensive shopping and transport facilities in Harrow Weald and Wealdstone, including Harrow & Wealdstone train station which has Bakerloo and London Overground trains into London and further afield. Whitefriars Primary, Middle and High Schools, rated Outstanding by OFSTED, are within a short walk as are Salvatorian Roman Catholic College and The Sacred Heart Language College.

CONTACT RAWLINSON GOLD

If you would like to arrange a viewing or discuss any aspect of this property, please contact our Harrow Office by telephone on 020 8861 2020 or by email at harrow@rawlinsongold.co.uk.

FREE MARKET APPRAISAL

Please contact our Harrow Office if we can be of assistance with the sale or rental of your current property.



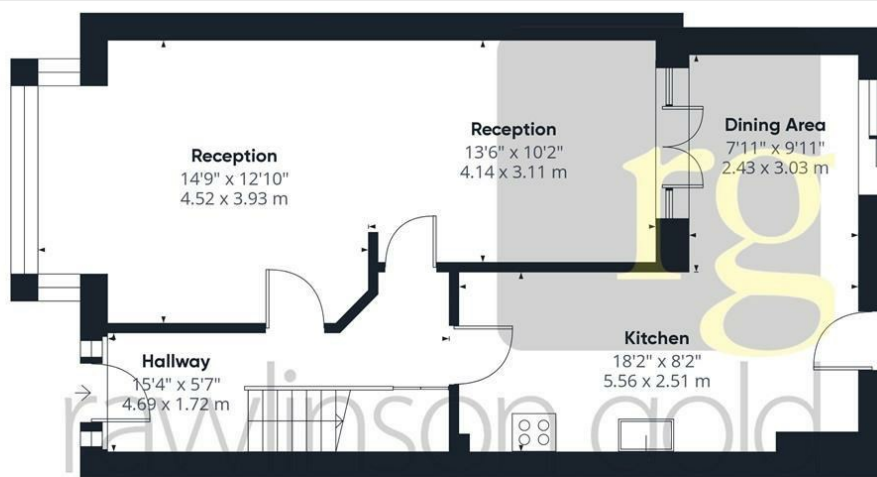

Ground Floor

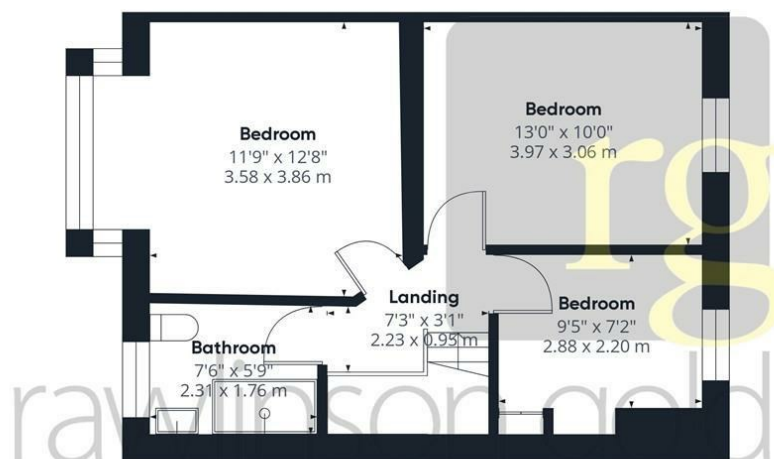

Floor 1

Approximate total area^m
 1094.67 ft²
 101.7 m²

(1) Excluding balconies and terraces.

While every attempt has been made to ensure accuracy, all measurements are approximate, not to scale. This floor plan is for illustrative purposes only.

Calculations are based on RICS IPMS 3C standard.

GIRAFFE360